

WEISER

SMARTCODE 10

TOUCHPAD ELECTRONIC DEADBOLT



How to Perform the Door Handing Process

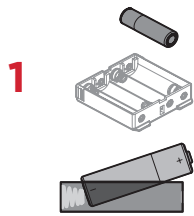

Install 4 AA batteries in battery pack.

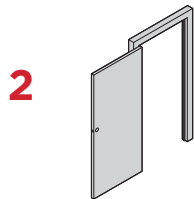

Make sure the door is open and the latch is extended.



Press and hold the Lock button. Do not release.

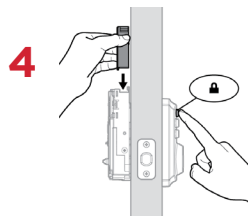

Insert the battery pack and continue holding the Lock button.

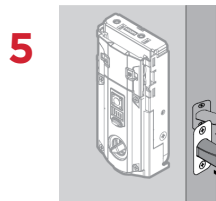

The latch bolt will retract and extend to learn the locking and unlocking direction of the door. Status LED will indicate success or failure.

Success: LED flashes green

Failure: LED remains solid red

Programming Video: <https://www.youtube.com/watch?v=WZSMiYoiuhM&t=49s>

THE LEADER IN RESIDENTIAL SECURITY

213826 10/17

WEISER

SMARTCODE 10

TOUCHPAD ELECTRONIC DEADBOLT



How to Add a Code:

1



Use a phillips screwdriver to remove the 2 set screws on the interior of the lock. Remove cover and set aside.

2



Make sure the door is open. Press the round program button that was under the cover you removed.

3

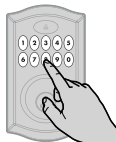

Enter new user code. Each user code must be a unique code between 4 and 8 digits.

4

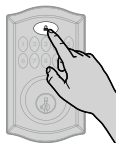

Press the "Lock" button once.

Green
(x1)



If programming is successful.

Red
(x3)

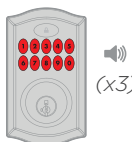

If programming is unsuccessful.

THE LEADER IN RESIDENTIAL SECURITY

WEISER

SMARTCODE 10

TOUCHPAD ELECTRONIC DEADBOLT



How to Remove a Code:

1



Use a phillips screwdriver to remove the 2 set screws on the interior of the lock. Remove cover and set aside.

2

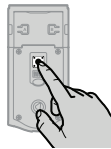

Make sure the door is open. Press the round program button that was under the cover you removed.

3

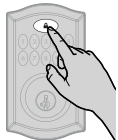

Press the "Lock" button once.

4

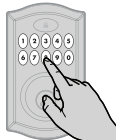

Enter new user code.

5

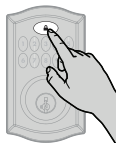

Press the "Lock" button once.

6

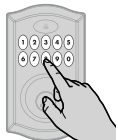

Re-enter new user code.

7

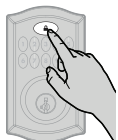

Press the "Lock" button once.

THE LEADER IN RESIDENTIAL SECURITY